



Facility Name: Cairns Sunshine Tower Hotel

Facility Type: Hotel/Apartments

Facility Address: 136-140 Sheridan St, Cairns

**Phone: 07 4051 5288 – within Australia
+61 7 4051 5288 – International**

**Fax: 07 4031 2483 – within Australia
+61 7 4031 2483 – International**

Email: res@sunshinetower.com.au

Web: www.sunshinetower.com.au

Reservations: 1300 659 074

Room numbers: Two accessible rooms



Entry into reception

Entry into reception is through double manual glass doors into an open level area with no steps or thresholds. The reception desk does not have a lowered section for wheelchair users, but staff are very friendly and will assist where necessary. In the reception area you will find a tour desk and internet café for you convenience.

Parking:

There are two designated accessible parking bays which are underneath the building with a lift access to the upper floors. There is also a laundry which has a 100 mm step, but is quite roomy once inside.



2 accessible car parks



100 mm step into laundry

Access to public areas

The restaurant and bar is across from the reception with level entry.



There is a pool which is up steps, so has no access.

Accommodation:

The accessible guest rooms are located on the second and third floor which has access by way of a lift, which has a clear opening of 880mm in the doorway and is 1509mm wide and 1707mm deep. There are no verbal announcements at each floor.

This information is regarding the room on the second floor.

Access into the room is over a level threshold with no sills, the door width is 770mm clear opening. The door requires some force to open and has a round knob which needs to be turned which pushing.



The bedroom is configured with a double and a single bed. Under bed clearance is 50mm and the height to the top of mattress is 510 mm. The widest clearance at the side of the bed is 940mm.



There is a writing desk provided with a height to the top of the desk at 840mm and a clear height from the floor of 610mm. There is a small bar fridge with tea and coffee making facilities. The wardrobe clothes rail is 1540mm from the floor and the light switches are positioned 1040mm from the floor.



There is a small balcony looking over Sheridan Street with a small lip, as seen the photo, although the other balcony door has a ramp.

Sanitary Facilities:

Entry into the accessible shower and toilet is through a 780mm clear opening door. The facility is a combined toilet and shower with a dimension of 2290mm long by 1900mm wide.

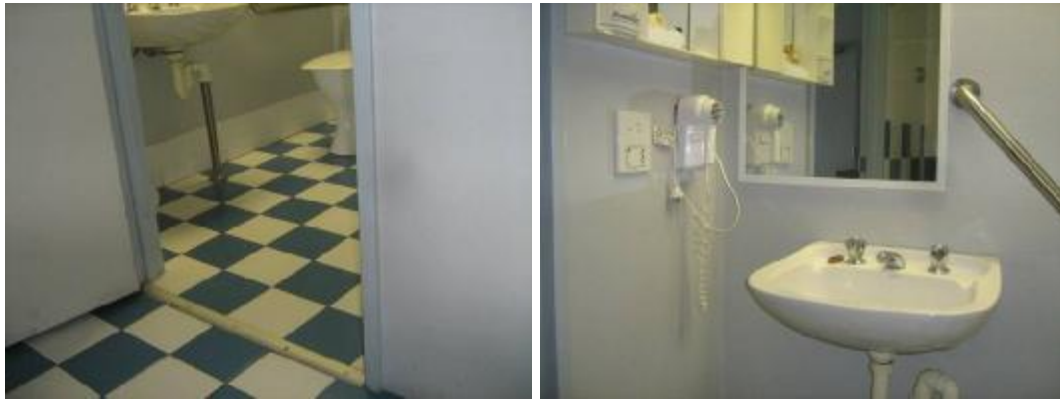

There is a portable shower seat provided. Clearance to the under side of the sink is 640mm with a height to top of sink at 765mm.

There is a horizontal grab rail which measures 920mm from the floor and the shower rose is on a sliding base.



Grab rails are fitted to the toilet and are mounted 720mm from the floor to top of grab rail. The height from the floor to the top of the pan seat is 445mm and 450mm from wall to centre of seat. There is only 330mm of space from the sink to the toilet, as shown in photo.



No emergency call button provided in the shower and toilet.

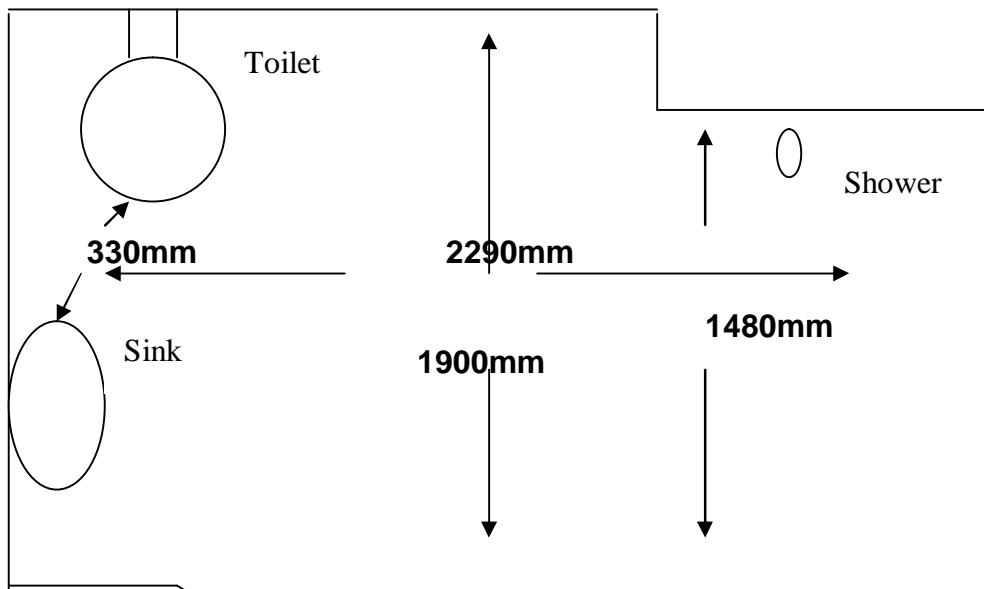

Diagram not drawn to scale.

General:

Staff are very friendly and will assist with baggage if required.

Assistance dogs are welcome on the premises.